

KIOSK INSTRUCTIONS

UNPACKING

1. To remove the carton from the pallet, start by removing the black strapping with a pair of scissors or utility knife. DO NOT cut the yellow strapping at this time. Once free, move the carton to where you ultimately want it located.
2. To remove the kiosk from the carton cut the yellow strapping and remove outer cartons.
3. You will find keys affixed to the hopper handle. Use the keys to open the main access door. (I) (Four anchor bolts and install instructions will be found on the inner right wall of the kiosk.)



INCLUDED HARDWARE

- Four drop-in anchors with setting tool, each with:
 - One 3/8" hex bolt and flat washer
 - One drop-in anchor (located on the inner right wall of kiosk)

TOOLS NEEDED

- 9/16" wrench
- Hammer
- Hammer Drill
- 1/2" concrete-appropriate drill bit

MOUNTING

1. Place your kiosk on a level, concrete or stone surface where you ultimately want it located. (Be sure your kiosk is in an area where there is enough clearance on the right side to open the access door a full 180 degrees)
2. Trace the outer diameter of the four 5/8" holes in the bottom of the kiosk onto the floor. (Once marked, set the kiosk aside)
3. With the 1/2" drill bit, drill out four holes. Each should be 1" deep. Center on each mark made in the previous step. (III)
4. Once the holes are drilled, clear any debris and set the anchor with the provided tool and align the kiosk with the four anchors.
5. Ensure a washer is on each of the 3/8" hex bolts.
6. Insert the four 3/8" hex bolts with washers through the kiosk into the anchors, then tighten each bolt with a 9/16" wrench to fully secure the kiosk to the floor.
7. Organize your kiosk related documents and reference the "Set-Up and Closing Assembling a Take-Back Kit" user instructions for the next steps.

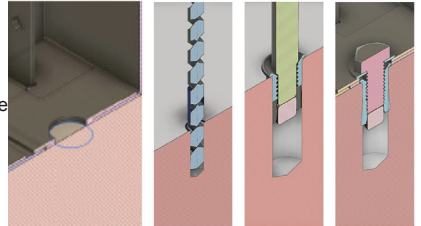

CARE

If your kiosk has a stainless steel finish, clean it monthly with an oil-based stainless steel cleaner.
 If your kiosk has a powder coat finish, clean it monthly with a warm, mild soap detergent and rinse it well with water.
 Use powdered graphite or lock lubricant to smooth the lock operation.